

Ordering code – Planetary gearbox

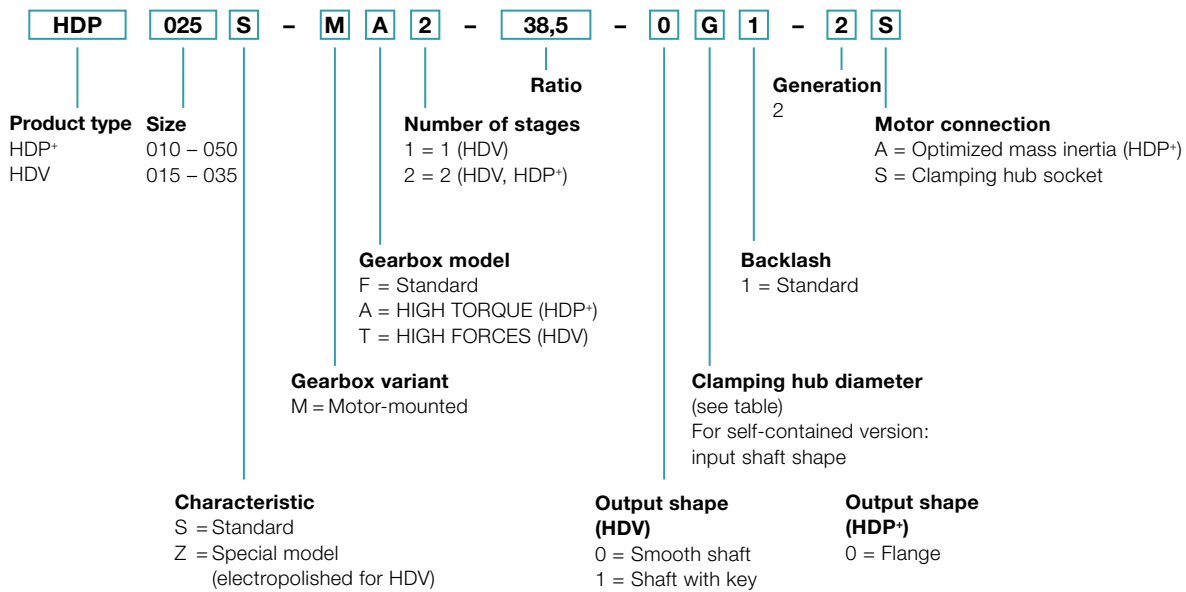

Mounting positions and clamping hub diameters

B5
Horizontal

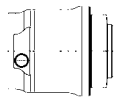

V1
Output vertical downwards

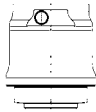

V3
Output vertical upwards

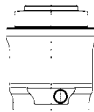

S
Can be tilted $\pm 90^\circ$
from a horizontal position

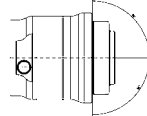

Clamping hub diameter
(see technical data sheet for possible diameters)

Code letter	mm	Code letter	mm
B	11	I	32
C	14	K	38
E	19	M	48
G	24	N	55
H	28	O	60

Intermediate sizes possible using bushings with a minimum thickness of 1 mm.

For information purposes only – not required when placing orders!

Exceptions:

- HDP+ is designed for mounting position B5 as standard!
- If the mounting position is different, contact WITTENSTEIN alpha.